

HYATT
REGENCY™
PARIS - CHARLES DE GAULLE



Reception





Designed by the architect Helmut Jahn, the hotel has 388 guestrooms and suites offering a modern and stylish decor as well as private outdoor parking with more than 300 places.

Hyatt Regency Paris - Charles de Gaulle is ideally located near Charles de Gaulle international airport (6 Km/3.7 Miles), the Villepinte exhibition center (3,6Km/2,3 Miles) and Bourget airport (10Km/6,2 Miles).

The hotel has free shuttle buses to Terminal 2 / TGV station & Terminal 3 / Roissy-pôle



Deluxe room



Regency Club Lounge

*388 Guestrooms & Suites
(including 101 twin rooms)*

- *311 Standard and Deluxe Rooms*
- *64 Club Rooms*
- *8 Junior Suites*
- *4 Executive Suites*
- *1 Presidential Suite*



Regency club room



Convention entrance



Plenary Room

Meeting rooms

Our 20 meeting rooms which benefit from natural daylight (except the ballroom) have a total surface of 20 000 square feet (2000m²). The biggest room, the plenary room which extends over 4850 square feet (450m²), has its own private entrance. High speed wifi access is available in all of the meeting rooms.

A large number of boardrooms are available for executive committees.

An exclusive floor is reserved for small meetings with dedicated staff for this area.



Saturne room



Foyer Apogée



Apogée room



Apogée room

FLOOR PLAN

GROUND FLOOR LEVEL

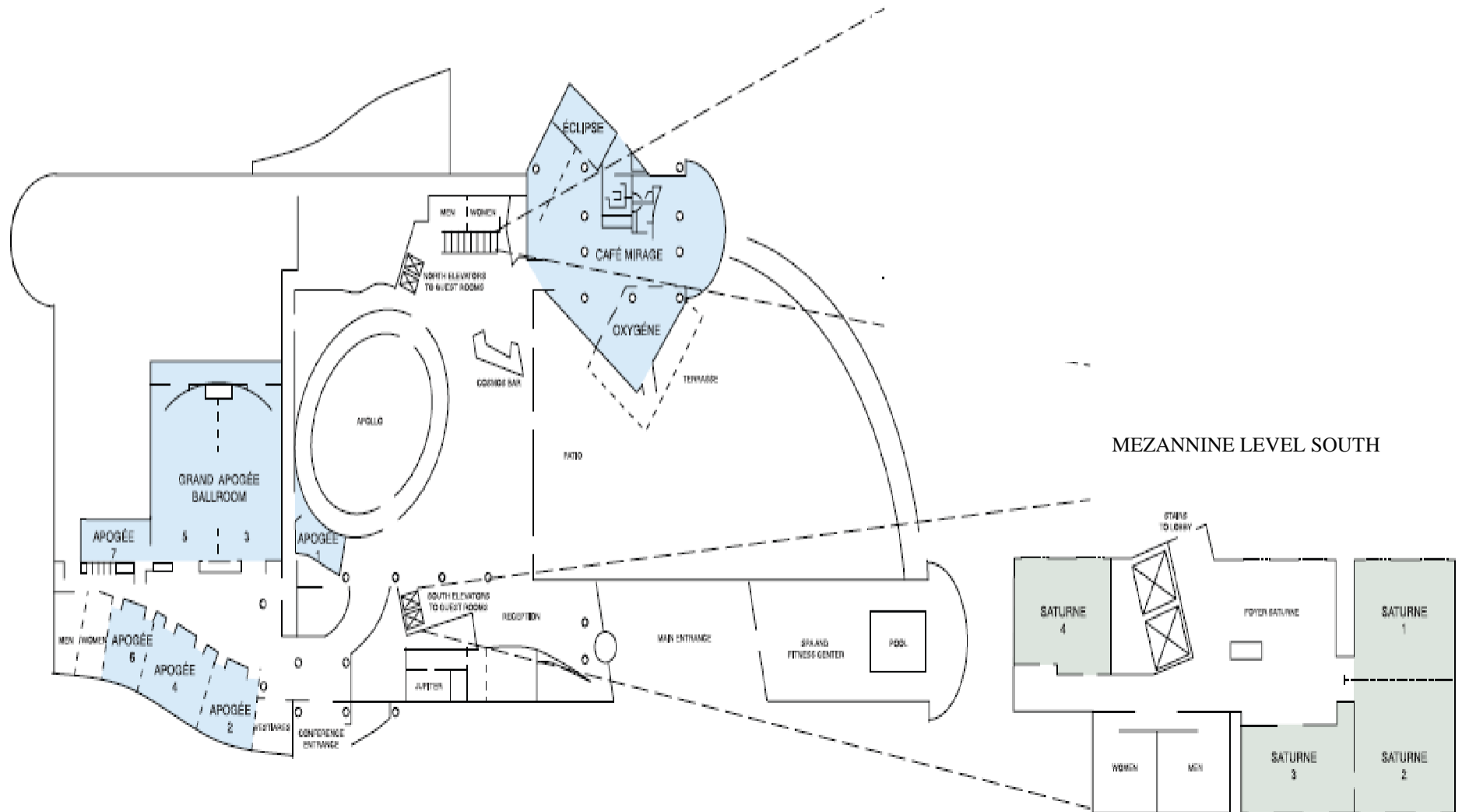

#INNOVATION



#CREATIVITY

#LECAMPUSCDG

More than an offer, an experience!



A GAME CHANGER IN THE MICE INDUSTRY

What is Le Campus?

- *A creative and customized answer for today's needs of business tourism,*
- *An open and customer-centric space for any guest who wants to enjoy a fun and innovative environment,*
- *A more flexible and connected solution designed by Viserius Studio, based in Paris and New-York, for a younger audience,*
- *An experience to make your own.*

Library



Game court





Picnic Area













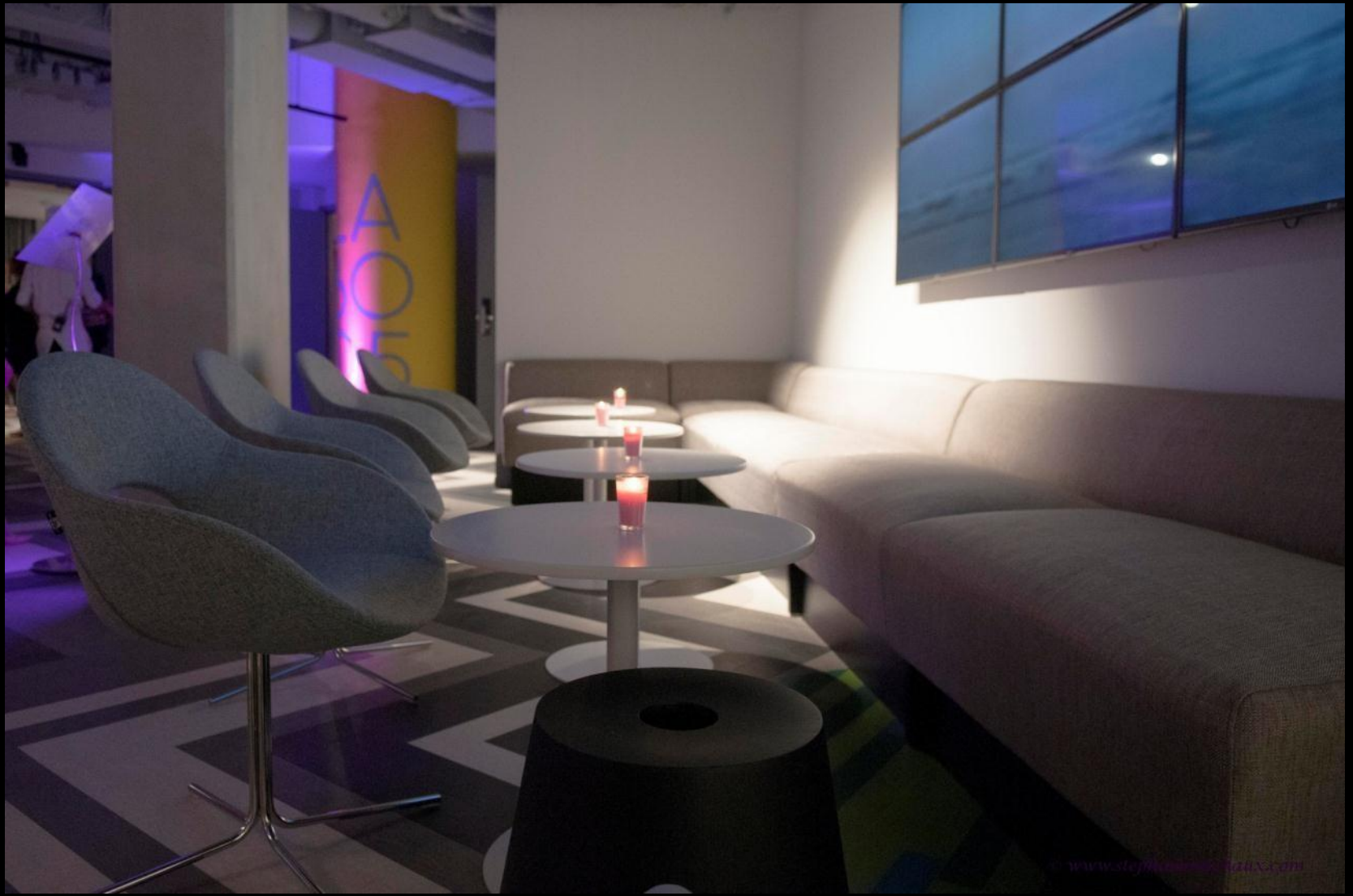













Le Campus space:

- *A personalized 800 m² space,*
- *7 private interactive LABS*
- *The Picnic Area,*
- *A shared multifunctional space with full access at all times.*

Le Campus services:

- *Fresh, delicious and organic finger food, available through the day, with eco-friendly packaging*
- *Optimum connectivity and multi-user broadband connection,*
- *HD/LED screens and AirPlay technology*



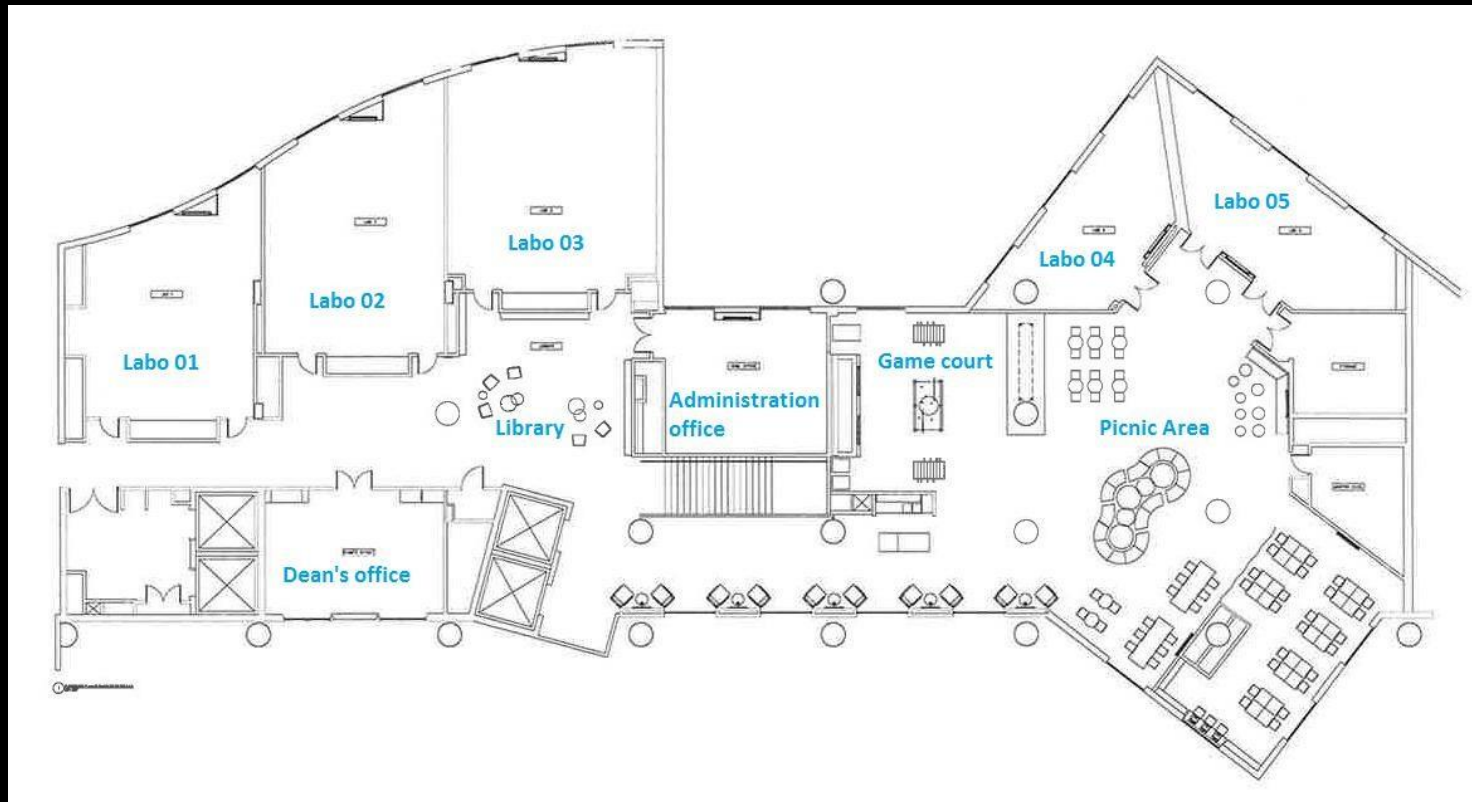

Administration Office (45 m²) up to 40 persons

Dean's Office (38 m²) up to 14 persons

Labo 01 (66 m²) up to 60 persons

Labo 02 (80 m²) up to 70 persons

Labo 03 (85 m²) up to 80 persons

Labo 04 (42m²) up to 9 persons

Labo 05 (47 m²) up to 40 persons



The Café Mirage

The Café Mirage is a dedicated area for groups with a maximum capacity of 250 seated persons or up to 300 persons for a cocktail.

This natural daylight area has an open kitchen and a private terrace.



The Café Mirage

The Apollo Restaurant

In the heart of the hotel, designed by renowned architect Helmut Jahn, you will find the Apollo restaurant, our all-day dining facility, featuring daily menus and a la carte selections using the freshest ingredients.

It is open everyday:

Lunch

Daily - 12:00 noon to 2:30pm

Dinner

Monday to Friday - 7:00pm to 11:00pm

Saturday and Sunday - 7:00pm to 10:00pm





The Apollo Restaurant

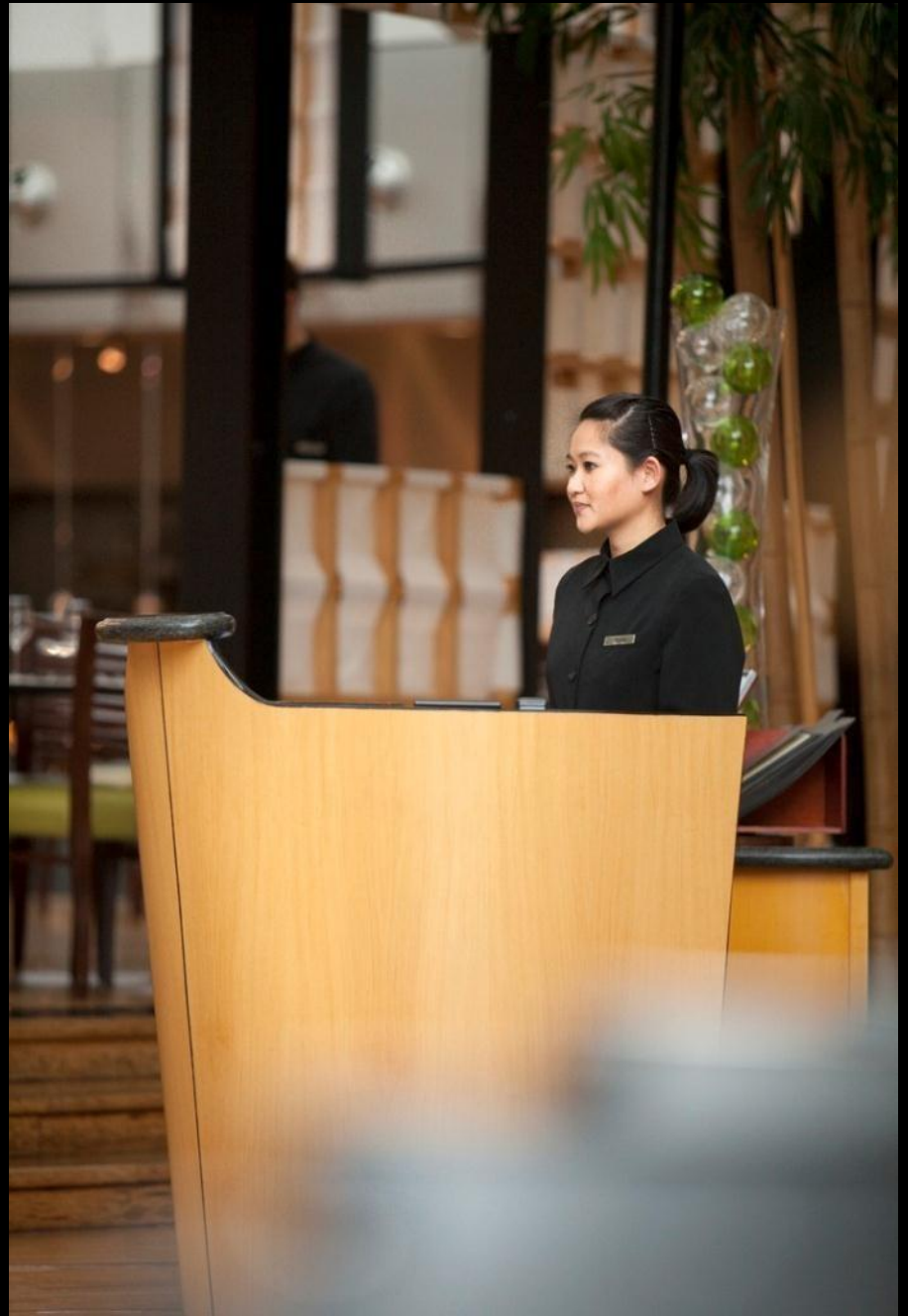



Cooking Lesson



Fitness Center

The Equinoxe fitness center allows you access to an array of modern fitness equipment and machines.

It also enjoys the largest heated indoor swimming pool in the Charles de Gaulle Airport area, a jacuzzi and a sauna.

Experience different massages, body treatments and manucures on request.

Outdoor tennis and basket courts are also available at any time.



Equinox Fitness center



Relaxing room

Women's experience

*Sometimes you forget things you need the most,
Hyatt has it.*

From curling irons to chargers,
Discover "Women's experience" by Hyatt





Paris International Golf Club, where guests enjoy privileged access

GREEN DRIVER

A premium transfer service available from the hotel: Green Driver – new eco-friendly private airport pick up with electronic car.

Week: from 07:00 am to 01:30pm and from 02:00 pm to 11:10pm

Saturday and Sunday: from 07:00 am to 02:00 pm and from 02:30pm to 09:00 pm

Guest calls the hotel when he/she arrives at the terminal under +33 1 48 17 12 12 to order the Green Driver. The driver will be there within 10 min to pick up the guest

Charge: EUR 10

Silver Line shuttle bus (complimentary but NOT operated by Hyatt)



Driving towards
a greener planet.

We introduce our new eco-friendly initiative, **Green Driver**, with our brand new electronic car - Renault Zoé – exclusively available at Hyatt Regency Paris - Charles de Gaulle. From the hotel, to the airport, Paris Nord 2, and more destinations.

For more information, please call +33 1 48 17 12 12.

SERVICES AVAILABLE
7 days a week

FROM
10€

WHEN YOU GO, GO GREEN

**HYATT
REGENCY**
PARIS
CHARLES DE GAULLE

HYATT REGENCY PARIS-CHARLES DE GAULLE
351 Avenue du Bois de la Pie, CS40048 - Paris Nord II
95012 Roissy Charles de Gaulle Cedex, France
paris.charlesdegaulle.hyatt.com

Keolis
Airport
By Transmancy

All rights reserved. HYATT, Hyatt, Regency and related marks are trademarks of Hyatt Corporation. © 2014 Hyatt Corporation. All rights reserved.



Thank you !

We look forward to working with you soon.